

# Drop-in Anchor ED-DW 15

Steel, zinc plated



## Description

Drop-in Anchor with DYWIDAG® internal thread<sup>1)</sup> DW 15 for post installed threadbar (DYWIDAG®) connections. Suitable for concrete C12/15-C50/60 or hard natural stone. Safe installation if debris makes the thread impassible. The Drop-in Anchor does not protrude out of the concrete after removing the threadbar.

## Applications

Multi-functional Anchor for concrete formwork. Cost efficient, quick fixing into existing concrete. Ideal for fixing one-sided formwork or temporary guardrails.



**Base Material:** concrete C12/15–C 50/60 or hard natural stone

## Drop-in Anchor ED-DW 15



- ➔ Steel, zinc plated
- ➔ For fixing threadbars in formwork

Description	Ref. No.	Drill hole Ø x depth mm	Thread Ø x length mm	Package content pcs.	Weight per package kg
ED-DW 15 x 80	05950101	22 x 80	DW 15 x 35	25	3,76

## Standard Setting Tool

for Drop-in Anchor ED-DW 15



Description	Ref. No.
E-SW 16 x 80 / DW-15 x 80	9505150

Recommended loads for ED-DW 15.

Total safety factor as per ETAG 001 included ( $\gamma_M$  and  $\gamma_F$ ).

Loads and performance data	Applied load angle		0°	15°	30°	45°	60°	75°	90°
			non-cracked concrete						
Recommended loads	C12/15	rec. F [kN]	17,3	16,9	16,8	17,4	18,7	20,6	22,6
	≥ C20/25	rec. F [kN]	19,3	18,7	18,3	18,6	19,5	21,1	22,6

## Spacing and edge distance

Effective anchorage depth	$h_{ef}$	[mm]	80
Minimum spacing	$s_{min}$	[mm]	600
Minimum edge distance	$c_{min}$	[mm]	300
Minimum thickness of concrete slab	$h_{min}$	[mm]	160

## Installation parameters

Drill hole diameter	$d_o$	[mm]	22
Depth of drill hole	$h_o$	[mm]	80
Length of thread	$L_{th}$	[mm]	35
Stab/Screw DW15 minimum installation depth		[mm]	28

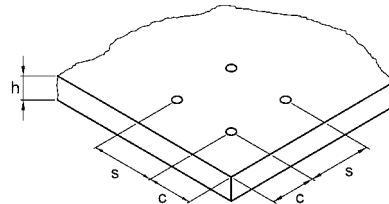
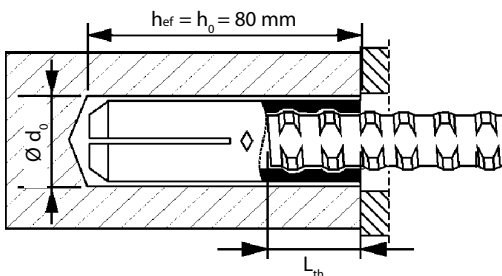
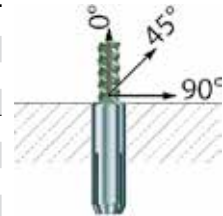

## Installation

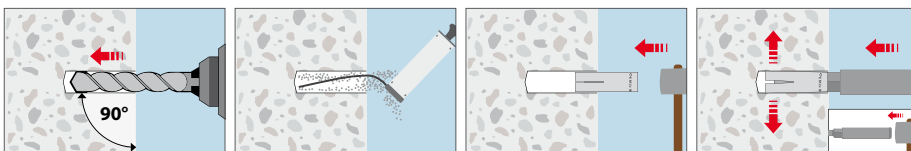

<sup>1)</sup> DYWIDAG® internal thread (DYWIDAG® is a registered trademark of Walter Bau AG)